

# Josephine

2 LEVEL TOWNHOME

1343 SQ. FT.

3 BEDROOMS + 2.5 BATHS

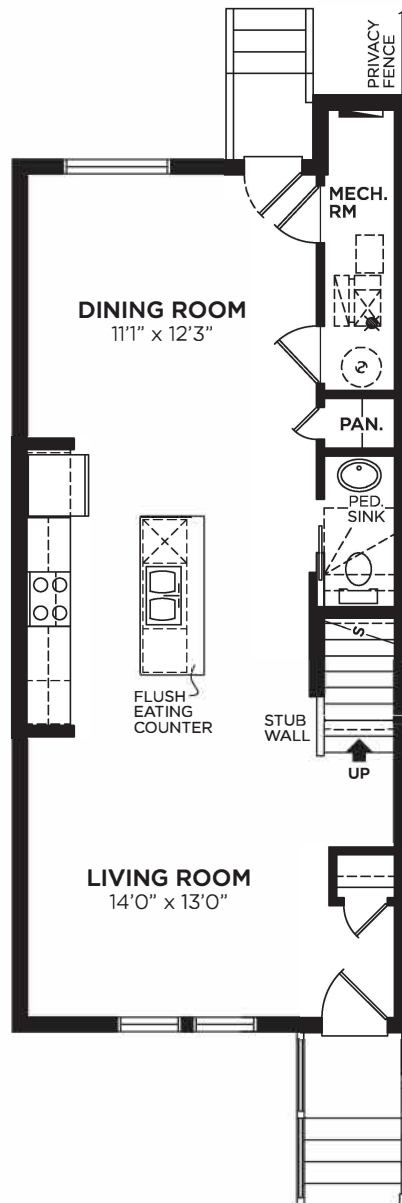

**MAIN FLOOR**  
680 SQ. FT.

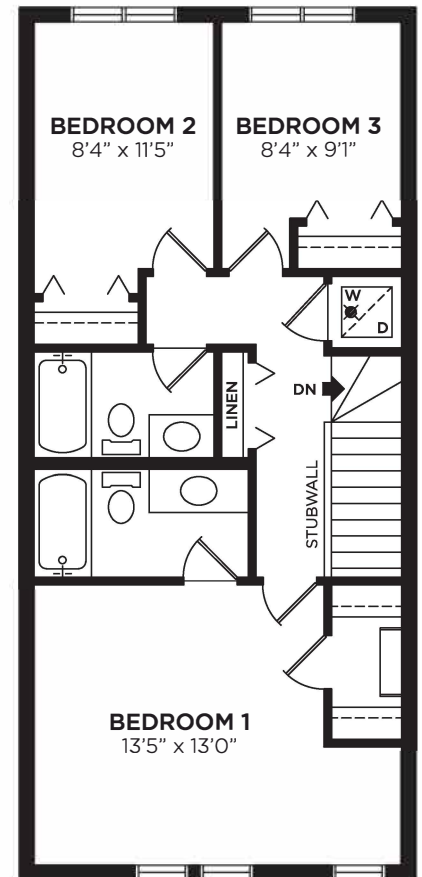

**UPPER FLOOR**  
663 SQ. FT.

*DIMENSIONS AND AREAS AS STATED IN REFERENCE TO ROOMS, SPACES OR FEATURES ARE MEASURED FROM THE APPLICABLE FACE OF FRAMING. THE OVERALL UNIT FLOOR PLAN AREA IS CALCULATED FROM THE CENTRE LINE OF THE PARTY WALLS AND TO THE EXTERIOR WALL AT FLOOR LEVEL. AHC RESERVES THE RIGHT TO MAKE MODIFICATIONS OR SUBSTITUTIONS WITHOUT NOTICE. ACTUAL FLOOR PLAN AND SQUARE FOOTAGE MAY NOT BE EXACTLY AS SHOWN. PLEASE NOTE A DIFFERENT MEASUREMENT METHODOLOGY MAY APPLY FOR THE PURPOSE OF THE CONDOMINIUM PROPERTY ACT THAT HAS BEEN UTILIZED FOR THE PURPOSE OF THIS DRAWING. SEE DISCLOSURE DOCUMENTS.*

**SALES REPRESENTATIVE**

Karen Payne

403.390.9310

karen.payne@attainyourhome.com